

TOWNSHIP 6 S., RANGE 9 W.W.M. TILLAMOOK, CO. ORE.

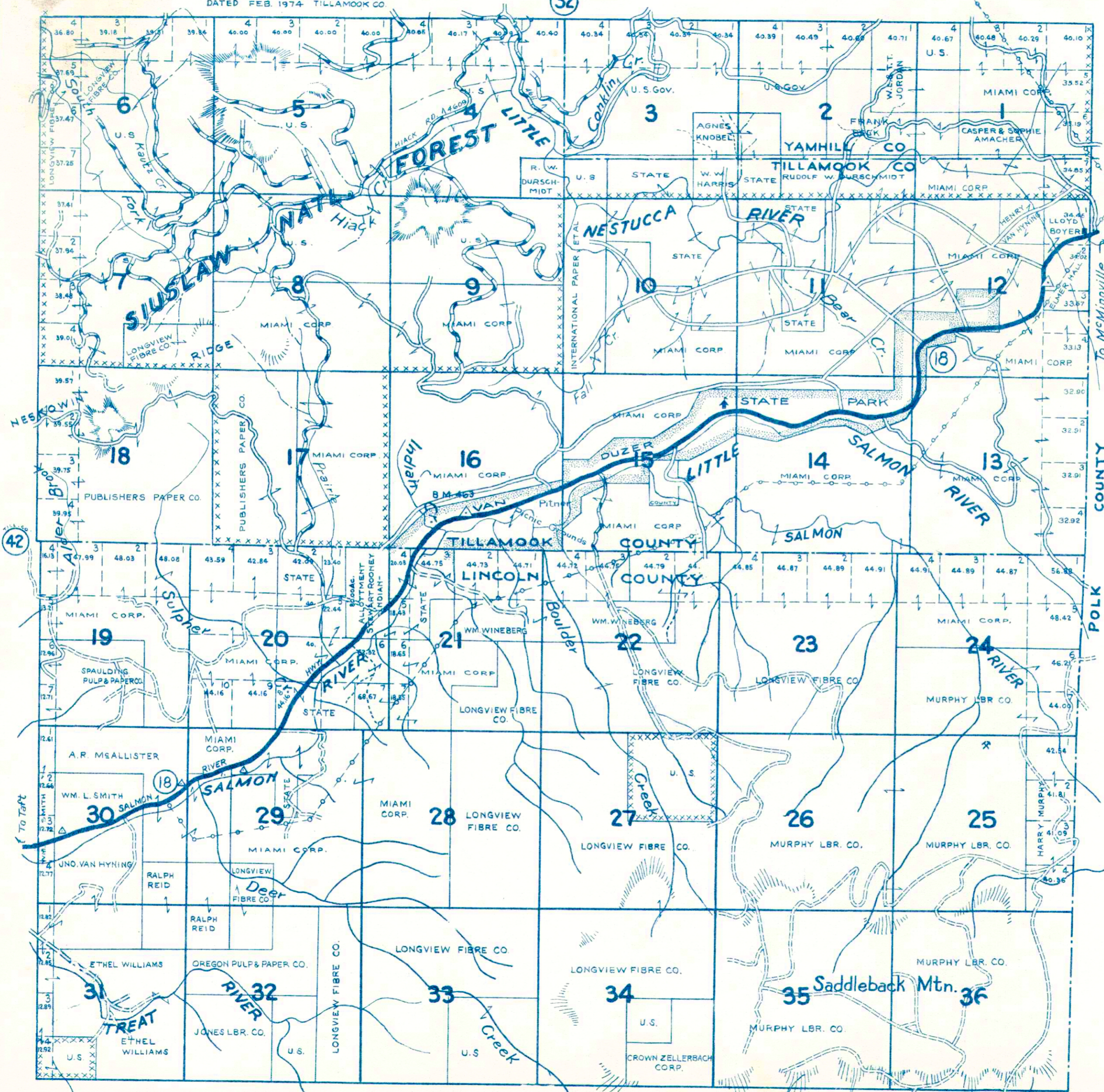

SMALL TRACTS
SEC. 15
I. S. PEDERSON

Reproduction in whole
or part for personal use or
resale is prohibited by law.

LEGEND

STATE HWY. ⑥	U.S. HWY. ①01
PAVED HIGHWAYS	—————
IMPROVED DIRT ROADS	———
DIRT ROADS	———
INFERIOR ROADS	———
RAILROADS	———
TRAILS	———
INTERMITTENT CREEKS	~~~~~
NAT'L FOREST BDY.	xxxxx
ELEC. PWR. TRANS. LINES	—o—o—